

Attachment 1

**Item No. 1**

35 pieces of Recycle Design Part #2535-060-WW – Replacement HDPE Lumber Slats for 5' Park series picnic tables and benches. Nominal 3 x 4 x 60 – or equal

Material – 100% recycled HDPE with UV inhibiting additives, Corrosion and Moisture resistant. Resists rotting, cracking, splintering, peeling without surface coating or treatment.

Dimensions – Exact 2.5" x 3.5" x 60"

Color – Recycle Design "Weathered" Color HDPE – exact match

Corner finish – rounded with 1/2" radius cut corners

Technical Data

<b>Mechanical Properties Test Method</b>	<b>Typical Value</b>
Density, lbs/cu.in.(ASTM D792)	.025-.028
Compressive Strength (ASTM D695) psi@ .2 in. def.	2540-2560
Compressive Strength (ASTM D695) psi@ .4 in. def.	3040-3120
Compressive Strength (ASTM D695) psi@ .6 in. def.	5130-5350
Tensile Strength, psi (ASTM D638)	2160-2630
Flexural Modulus, psi (ASTM D790)	97900-10330
Coeff. of Thermal Exp. in/in/A F (ASTM D696)	0.00007
Accel. Weath. >1MM Langleys (ASTM E838)	0.91% color>

Attachment 1

**Item No. 2**

30 pieces of Recycle Design Part #**3400-060-WW** - Replacement HDPE Lumber Slats for 5' Park series picnic tables and benches. Nominal 3 x 4 x 60 "Bullnose" profile on one side. - or equal

Material – 100% recycled HDPE with UV inhibiting additives, Corrosion and Moisture resistant. Resists rotting, cracking, splintering, peeling without surface coating or treatment.

Dimensions – Exact 2.5" x 3.5" x 60"

Color – Recycle Design "Weathered" Color HDPE – exact match

Corner finish – rounded with 1/2" radius cut corners

"Bullnose" profile with 1.25" radius on one 2.5" side

Technical Data

<b>Mechanical Properties Test Method</b>	<b>Typical Value</b>
Density, lbs/cu.in.(ASTM D792)	.025-.028
Compressive Strength (ASTM D695) psi@ .2 in. def.	2540-2560
Compressive Strength (ASTM D695) psi@ .4 in. def.	3040-3120
Compressive Strength (ASTM D695) psi@ .6 in. def.	5130-5350
Tennsile Strength, psi (ASTM D638)	2160-2630
Flexural Modulus, psi (ASTM D790)	97900-10330
Coeff. of Thermal Exp. in/in/A F (ASTM D696)	0.00007
Accel. Weath. >1MM Langleys (ASTM E838)	0.91% color>

Attachment 1

**Item No. 3**

21 pieces of Recycle Design Part #2535-072-WWW - Replacement HDPE Lumber Slats for 6' Park series picnic tables and benches. Nominal 3 x 4 x 72 – or equal

Material – 100% recycled HDPE with UV inhibiting additives, Corrosion and Moisture resistant. Resists rotting, cracking, splintering, peeling without surface coating or treatment.

Dimensions – Exact 2.5" x 3.5" x 72"

Color – Recycle Design "Weathered" Color HDPE – exact match

Corner finish – rounded with 1/2" radius on cut corners

Technical Data

<b>Mechanical Properties Test Method</b>	<b>Typical Value</b>
Density, lbs/cu.in.(ASTM D792)	.025-.028
Compressive Strength (ASTM D695) psi@ .2 in. def.	2540-2560
Compressive Strength (ASTM D695) psi@ .4 in. def.	3040-3120
Compressive Strength (ASTM D695) psi@ .6 in. def.	5130-5350
Tensile Strength, psi (ASTM D638)	2160-2630
Flexural Modulus, psi (ASTM D790)	97900-10330
Coeff. of Thermal Exp. in/in/A F (ASTM D696)	0.00007
Accel. Weath. >1MM Langleys (ASTM E838)	0.91% color>

**Item No. 4**

35 pieces of Recycle Design Part #**3400-072-WW** - Replacement HDPE Lumber Slats for 6' Park series picnic tables and benches. Nominal 3 x 4 x 72 "Bullnose" profile on one side. – or equal

Material – 100% recycled HDPE with UV inhibiting additives, Corrosion and Moisture resistant. Resists rotting, cracking, splintering, peeling without surface coating or treatment.

Dimensions – Exact 2.5" x 3.5" x 72"

Color – Recycle Design "Weathered" Color HDPE – exact match

Corner finish – rounded with 1/2" radius on cut corners

"Bullnose" profile with 1.25" radius on one 2.5" side

Technical Data

<b>Mechanical Properties Test Method</b>	<b>Typical Value</b>
Density, lbs/cu.in.(ASTM D792)	.025-.028
Compressive Strength (ASTM D695) psi@ .2 in. def.	2540-2560
Compressive Strength (ASTM D695) psi@ .4 in. def.	3040-3120
Compressive Strength (ASTM D695) psi@ .6 in. def.	5130-5350
Tensile Strength, psi (ASTM D638)	2160-2630
Flexural Modulus, psi (ASTM D790)	97900-10330
Coeff. of Thermal Exp. in/in/A F (ASTM D696)	0.00007
Accel. Weath. >1MM Langleys (ASTM E838)	0.91% color>

**Item No. 5**

50 pieces of Recycle Design Part #2535-096-WWW - Replacement HDPE Lumber Slats for 8' Park series picnic tables and benches. Nominal 3 x 4 x 96 – or equal

Material – 100% recycled HDPE with UV inhibiting additives, Corrosion and Moisture resistant. Resists rotting, cracking, splintering, peeling without surface coating or treatment.

Dimensions – Exact 2.5” x 3.5” x 96”

Color – Recycle Design “Weathered” Color HDPE – exact match

Corner finish – rounded with ½” radius on cut corners

Technical Data

<b>Mechanical Properties Test Method</b>	<b>Typical Value</b>
Density, lbs/cu.in.(ASTM D792)	.025-.028
Compressive Strength (ASTM D695) psi@ .2 in. def.	2540-2560
Compressive Strength (ASTM D695) psi@ .4 in. def.	3040-3120
Compressive Strength (ASTM D695) psi@ .6 in. def.	5130-5350
Tennsile Strength, psi (ASTM D638)	2160-2630
Flexural Modulus, psi (ASTM D790)	97900-10330
Coeff. of Thermal Exp. in/in/A F (ASTM D696)	0.00007
Accel. Weath. >1MM Langleys (ASTM E838)	0.91% color>

**Item No. 6**

30 pieces of Recycle Design Part #**3400-096-WW** - Replacement HDPE Lumber Slats for 8' Park series picnic tables and benches. Nominal 3 x 4 x 96 "Bullnose" profile on one side – or equal

Material – 100% recycled HDPE with UV inhibiting additives, Corrosion and Moisture resistant. Resists rotting, cracking, splintering, peeling without surface coating or treatment.

Dimensions – Exact 2.5" x 3.5" x 96"

Color – Recycle Design "Weathered" Color HDPE – exact match

Corner finish – rounded with 1/2" radius cut corners

"Bullnose" profile with 1.25" radius on one 2.5" side

Technical Data

<b>Mechanical Properties Test Method</b>	<b>Typical Value</b>
Density, lbs/cu.in.(ASTM D792)	.025-.028
Compressive Strength (ASTM D695) psi@ .2 in. def.	2540-2560
Compressive Strength (ASTM D695) psi@ .4 in. def.	3040-3120
Compressive Strength (ASTM D695) psi@ .6 in. def.	5130-5350
Tennsile Strength, psi (ASTM D638)	2160-2630
Flexural Modulus, psi (ASTM D790)	97900-10330
Coeff. of Thermal Exp. in/in/A F (ASTM D696)	0.00007
Accel. Weath. >1MM Langleys (ASTM E838)	0.91% color>

**Item No. 7**

16 of Recycle Design part #**PAR. CON. SE. 072.SM (9884)** Park Contour Seat – Armless Surface Mounted 72” Bench - with Recycle Design part #**9100-044-ARM** – Center Arm for Park Contour Seat – or equal.

One Arm included - Recycle Design part #**9100-044-ARM** – Center Arm for Park Contour Seat.  
Support Frame Material – Powder Coated Steel  
Support Frame Color – Recycle Design “Green” powder coating  
Support Frame Mounting – Surface mounted on top existing concrete slabs with concrete sleeve anchors through support base  
Seat and Backrest material – 100% Recycled HDPE lumber slats with UV inhibiting additives, corrosion and moisture resistant. Resists rotting, cracking, splintering, peeling without surface coating or treatment. 2.5”x3.5”x72” HDPE lumber slats secured to steel supports with stainless steel screws at ½” spacing. Bullnose with 1.25” radius on end HDPE lumber slats.  
Seat and Back rest color – Recycle Design “Weathered” Color – exact match  
All fasteners used will be stainless steel  
See drawing for dimensions (in inches) and construction:

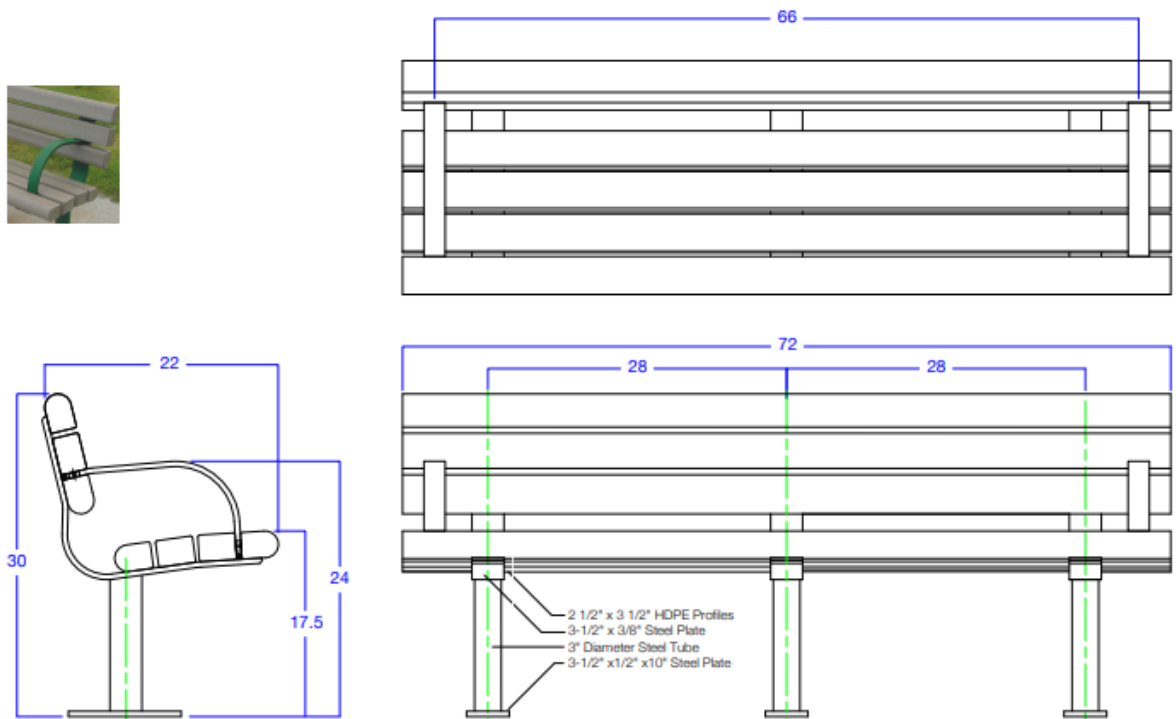

**Item No. 8**

5 of Recycle Design part #**PAR.PT.096.SM (9858)** – 96” Surface Mounted “Park” Picnic Table ADA Both Ends, , “Weathered” Color HDPE, Green Powder Coating – or equal

- Support Frame Material – Powder Coated Steel
- Support Frame Color – Recycle Design “Green” powder coating
- Support Frame Mounting – Surface mounted on top existing concrete slabs with concrete sleeve anchors through support base
- Table top and seat material – 100% Recycled HDPE lumber slats with UV inhibiting additives, corrosion and moisture resistant. Resists rotting, cracking, splintering, peeling without surface coating or treatment. 2.5”x3.5”x96” HDPE lumber slats secured to steel supports with stainless steel screws at ½” spacing. Bullnose with 1.25” radius on end HDPE lumber slats.
- Bench and table top color – Recycle Design “Weathered” Color – exact match
- All fasteners used will be stainless steel
- See drawing for dimensions (in inches) and construction:

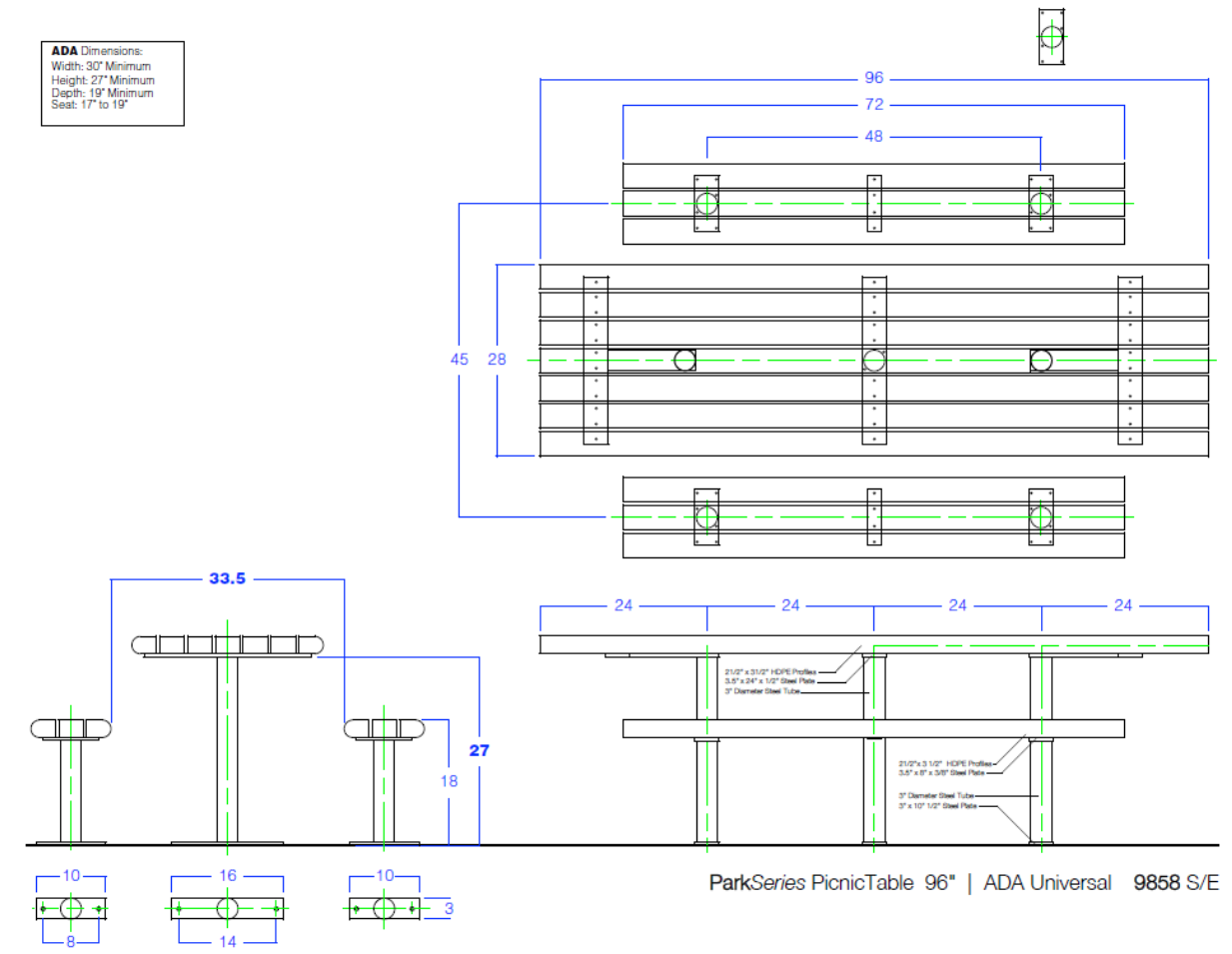

Attachment 1

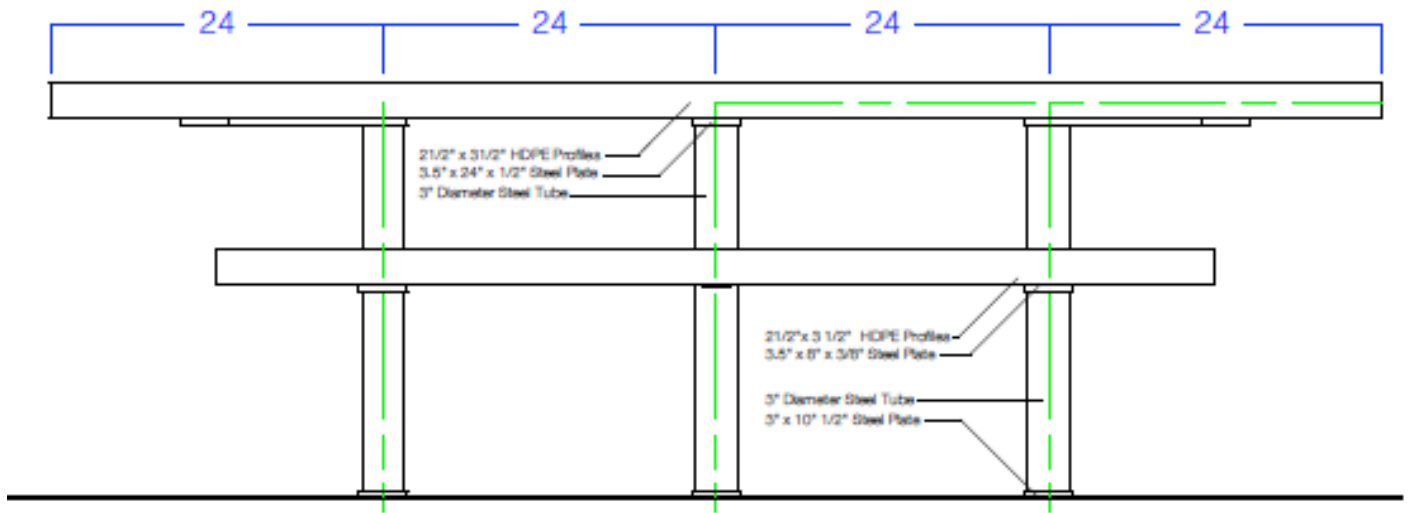

**Item No. 9**

200 of 3/8" x 2/12-3" concrete sleeve anchors with T-45 security head – see picture.

